

FOR APPROVAL

APPROVED BY: _____

DATE: _____

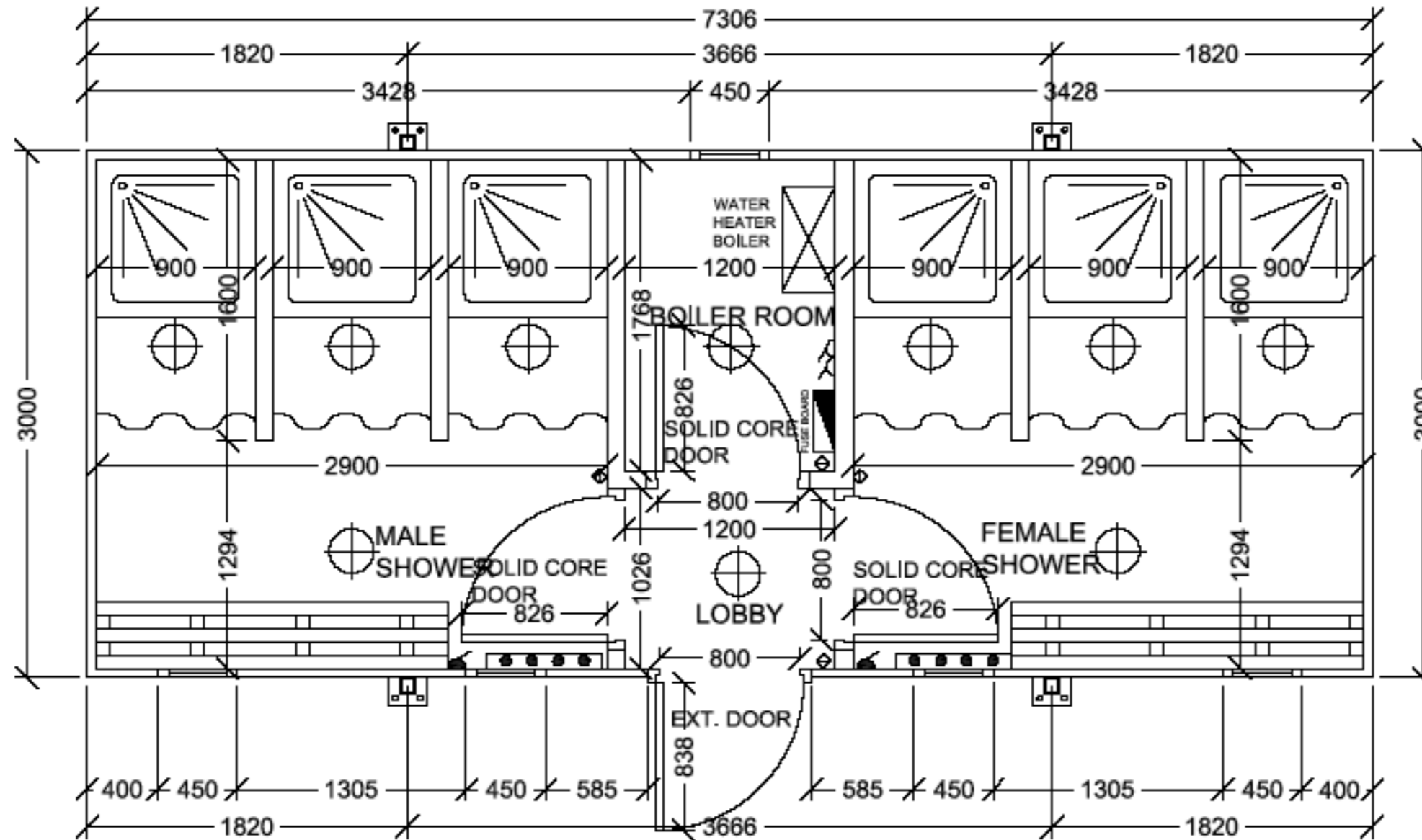
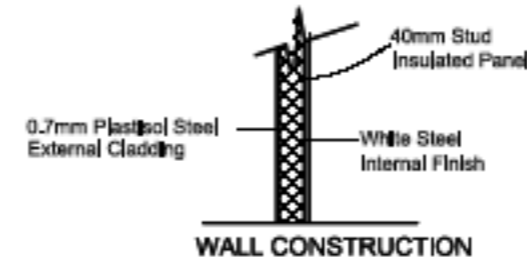
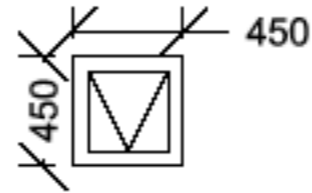

ELECTRICAL LEGEND

- 2D LIGHT FITTING
- OIL FILLED HEATER
- FUSED SPUR
- ELCB FUSE BOARD
- 13A TWIN SOCKET (SWITCHED)

Notes

TIMBER FRAMED SPECIFICATION

Roof:
 100 x 38mm Timber Roof Joists.
 18mm OSB
 Marley Roof Blanket PVC Membrane

External Walls: -53mm
 0.7mm Plastic Coated Steel - Goosewing Grey
 40x55mm Timber Frame
 40mm High Density Polystyrene Insulation
 White Steel Cladding Internal Finish

Ceiling:
 12.5mm Vinyl Faced Plasterboard
 2350mm Floor to Ceiling Height

Floors:
 Aluminium Insulation Sheet
 125 x 50mm Timber joists
 18mm Structural Plywood
 Non-Slip Vinyl Floor Covering

Internal Partitions: -100mm
 70x38mm Timber Studs
 70mm Fiberglass Insulation
 1No. Layer of White Steel

Windows:
 5 No. 450 x 450mm White PVC Double Glazed Units

Doors:
 1 No. 838mm Steel Bonded External Door
 3 No. 826mm Internal Solid Core Doors

Electrical:
 1 No. ELCB Fuse Board
 10 No. 2 - D Lights
 2 No. Oil Filled Heaters on own spurs
 1 No. Double Socket

Mechanical:
 6 No. 900 x 900mm Showers c/w trays
 1 No. Water Heater Boiler
 1 No. Water Tank

Other Items:
 2 No. 2m Benching
 6 No. Shower Curtains

Jacklegs/Trims:
 Heavy Duty Jacklegs- Ocean Blue
 Trims- Ocean Blue

No.	Revision	Date

Convenience Services LTD

By telephone +44 (0) 845 006 0737
 By Fax +44 (0) 1635 298 548

Client

Project
 24' x 10' Timber Framed Shower Unit

Drawing Title
 Floor Plan

Scale 1:50@A4	Drawing No. 07-0717-01
Date	
Drawn	